

## Roof Mounted Cycle Carrier Fitting Instructions

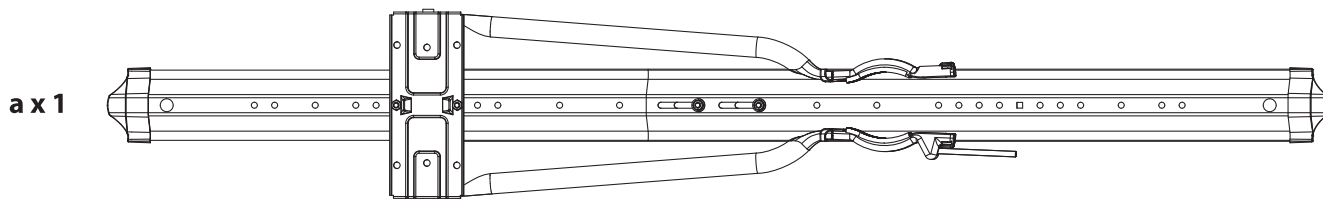

### PV 135

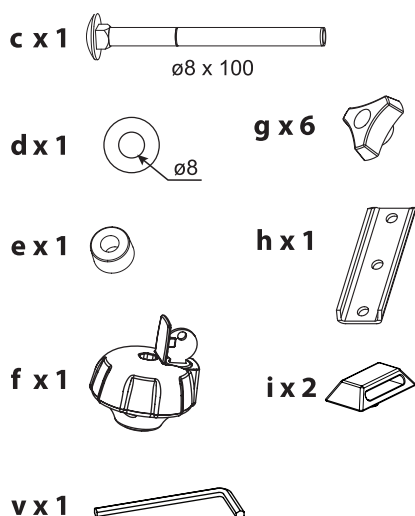

### PV 181

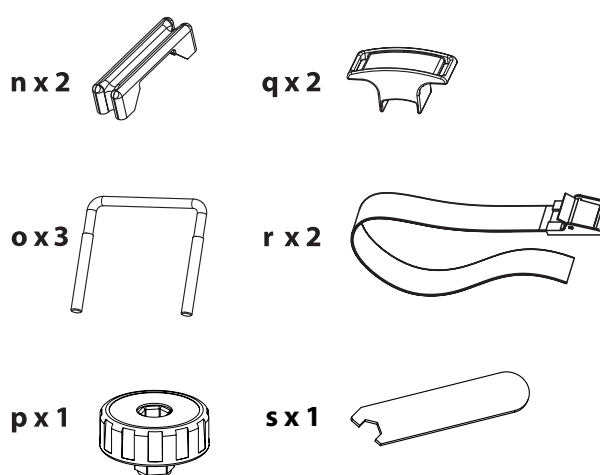

### Down tube profiles

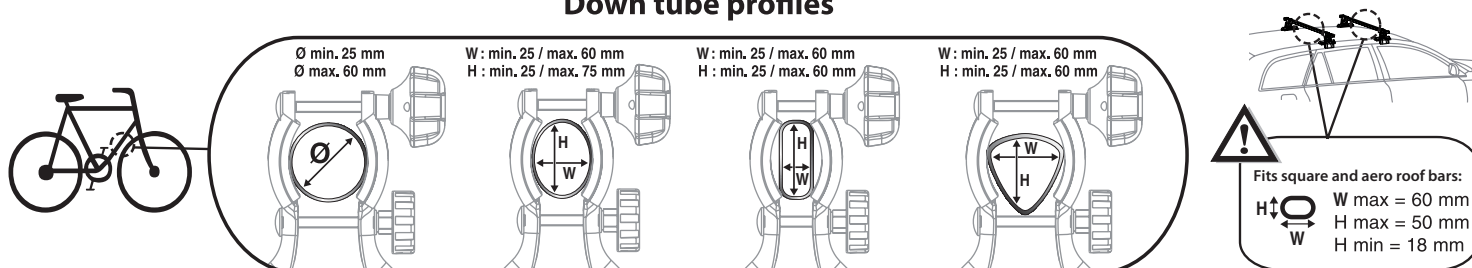

Réf. imp.: 058188 / A16-3



= Max. 15 kg

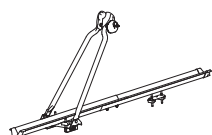

product weight = 3 kg

SPEED  
LIMIT



MPH



Keep these instructions for future use.

# Assembly and fitting

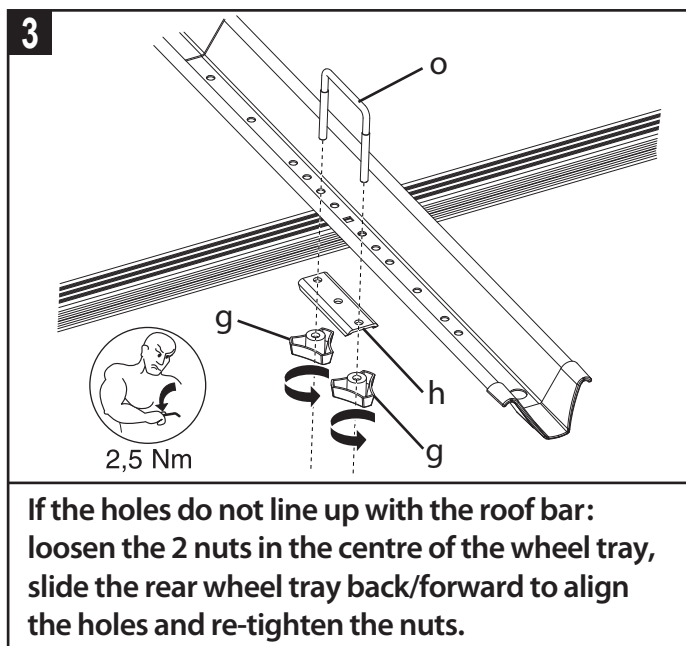
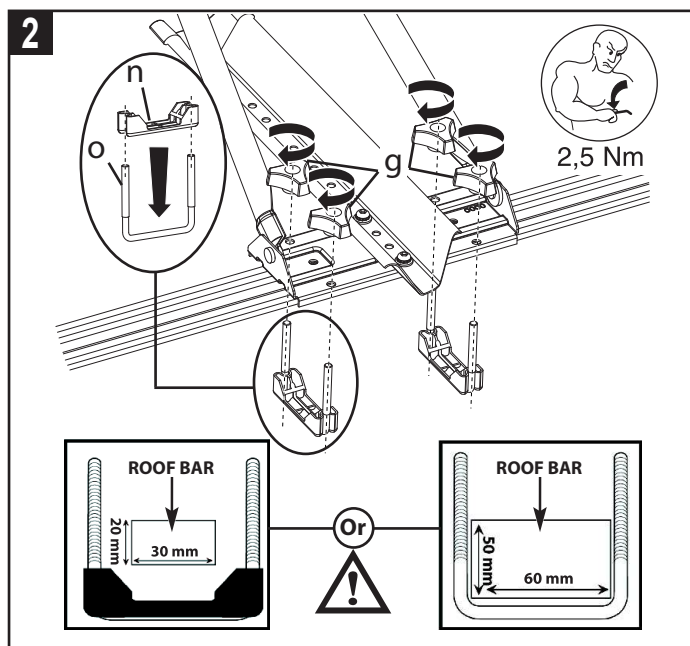
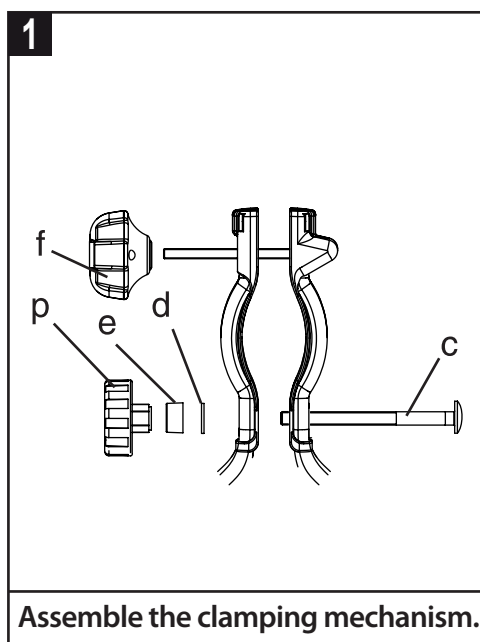
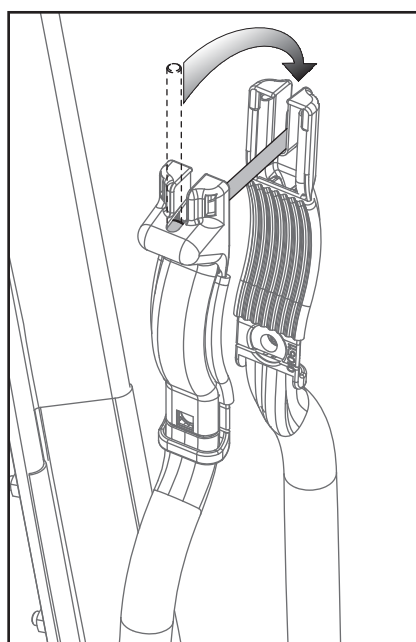
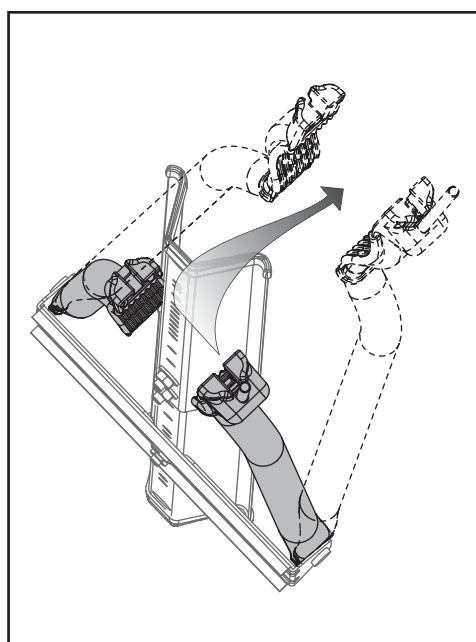
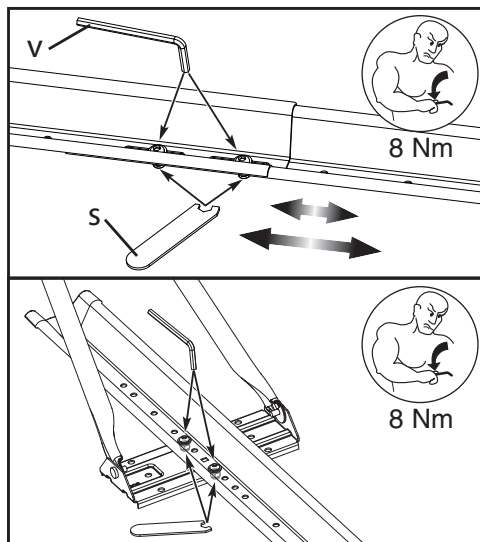
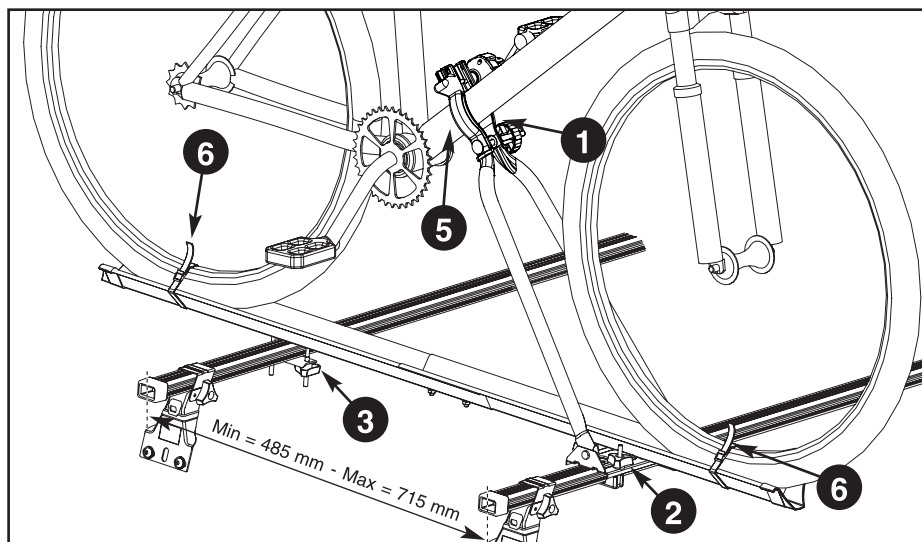

# Positioning the bike

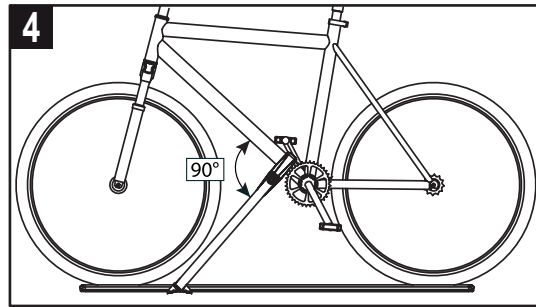

**5**

**5-a**

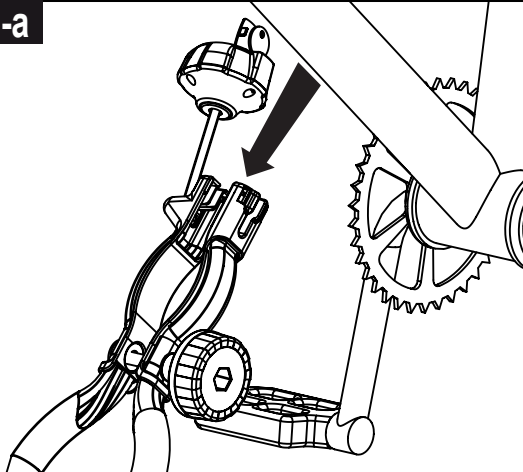

Place the wheels onto the wheel tray and roll the bike into the frame clamp.

**5-b**

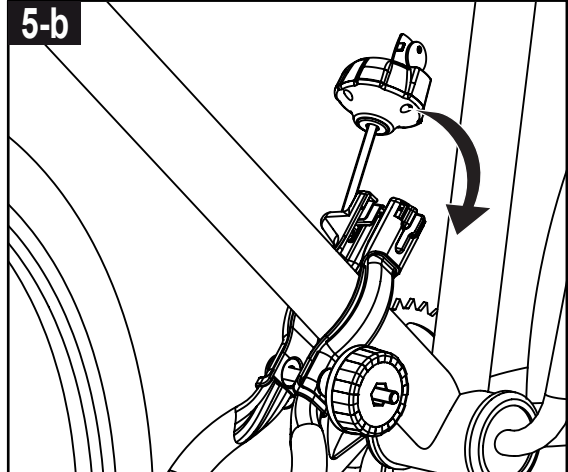

Flip the locking bar down into the slot.

**5-c**



180°

Turn the key anti-clockwise to allow the clamp to tighten.

**5-d**

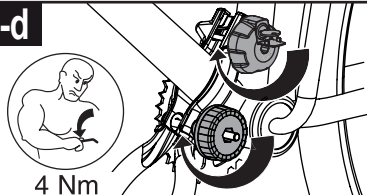

4 Nm

Tighten the clamps so there is an even gap between the two arms (above and below the bike frame).

**5-e**



180°

Turn the key clockwise to disengage the handle. It should now spin freely without undoing the clamp.

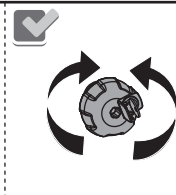

**6**

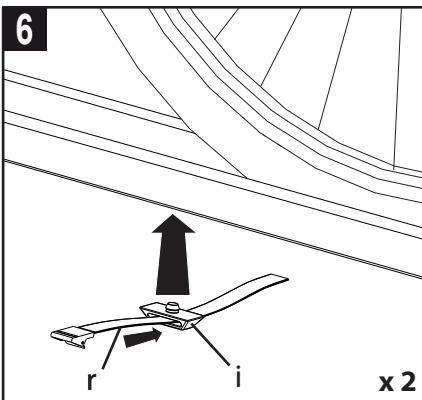

x 2

**7**

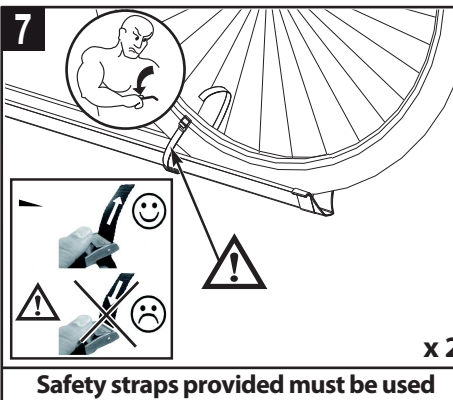

x 2

Safety straps provided must be used

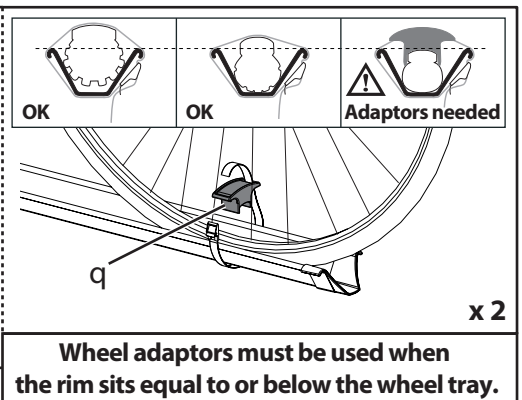

Wheel adaptors must be used when the rim sits equal to or below the wheel tray.

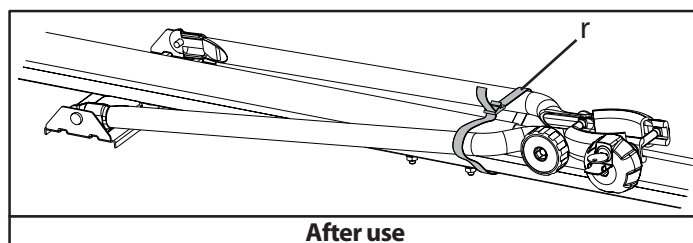

After use

# Important Instructions

- Retain these instructions for future reference, and ensure that any other users of the cycle carrier are familiar with the contents.
- Please read the fitting instructions carefully.
- Make sure that all parts are included in the package.
- Prior to fitting ensure that the vehicle roof bars are free from dirt and grime.
- This cycle carrier is suitable for roof bars measuring less than 60mm in width and between 50mm to 18mm in depth.
- Both wheels must be securely strapped to the carrier using the supplied straps.
- Locking mechanism is only designed to be a theft deterrent, keep bicycles in sight at all times.
- **IMPORTANT!** Carrier clamping mechanisms must always be re-tightened after cycle has been mounted to the carrier.
- After driving for a few miles STOP and check that all clamping mechanisms are secured and tight. This must be repeated at suitable intervals depending on the nature of the road.
- When using the carrier the driving handling characteristics of your vehicle will change. Driving techniques should be altered to allow for this. Reduce speeds (max 70mph) and allow longer braking distances.
- The maximum permissible roof loads must not be exceeded (see vehicle handbook for details of the maximum roof loads). The roof load will comprise of the weight of the load bars, the carrier plus additional racks and the cycle load. Do not exceed a maximum load of 15kg per cycle carrier (1 adult cycle).
- When fitted, the roof bars will affect your fuel economy, therefore please remove when not in use.
- Take care not to drive in low places such as garages and multistorey car parks.
- When positioning cycles on the carrier ensure that they do not project beyond the profile of the vehicle and that no part of the cycle can touch the paintwork.
- The use of cycle carriers may be restricted in certain countries outside the UK. Always check with the relevant national authorities prior to commencing your journey.
- Do not put the car through an automatic car wash with the load carrier mounted.
- Ensure this carrier is maintained and kept in good working order.
- Ensure that all loose accessories such as baskets, lights, child seats are removed from the bicycle before fitting to the carrier.

The Halfords logo, consisting of the word "halfords" in a bold, white, sans-serif font, set against a solid black rectangular background.

Made in the EU  
Halfords Ltd, Icknield Street Drive, Washford West  
Redditch, B98 0DE  
visit us at... [www.halfords.com](http://www.halfords.com)  
Item Code: 210127