

Trouble shooting

Should your child's electric vehicle fail to operate after some time in service we recommend the following:

- Check the connectors. Are they still joined?
If the battery connector, or one of the loom connectors, has not been securely clipped together, then the vehicle's electric circuit may be "Open" i.e. the power is not reaching the On/Off switch, the accelerator pedal/button and hence the motor. Check the connectors.
- Has the electric motor or the electrics got wet?
Water can harm and damage the motor and electrics. If you suspect there has been ingress of water, leave the vehicle in a warm room for 24 hours to dry out. If a hairdryer is available, warm air (not hot) can be blown on to the motor and electrics to aid in the drying process.

Disposal and Recycling

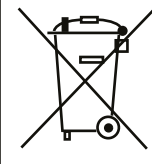

Electrical product waste should not be discarded with household waste. Please actively support us in conserving resources and protecting the environment by returning the non-working electrical products to an appropriate disposable/recycling centre (if available).

IMPORTANT

please contact our helpline on customer service number 01253775570, if any enquires. Save all packaging material until assembly is completed.

VER: 0614



Please read the instructions fully before use.
Failure to do so may result in damage to the vehicle or harm to the user.
Please keep this handbook for future reference.



Designed & Manufactured by HTI Group, FY7 7NY, UK
Please retain these details for future reference.

Installment

1. Install the handlebar and steering column.

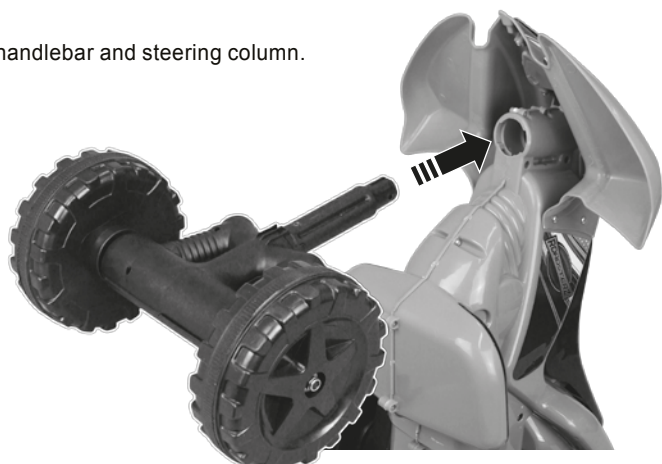

2. Put through the hole on the top of the ride on body.
Ensure the end of the steering column locates correctly into the front axle.
3. Tighten the washer and nut.



Page 1

Battery Charging

The vehicle comes with the battery disconnected. Please connect the battery and fully charge before use (refer to Battery Charging section). Please read Cautions for Safety & Cautions of Charging in the manual before proceeding.

1. Loosen the screw with a screwdriver and open seat.
2. Connect the battery cable.

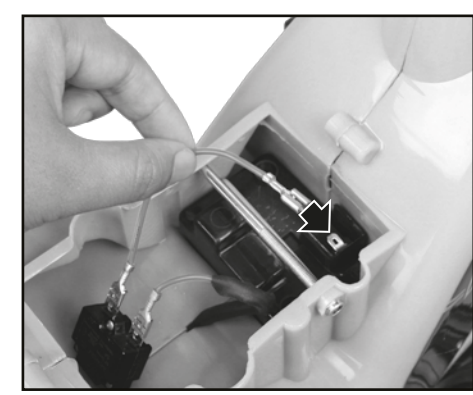
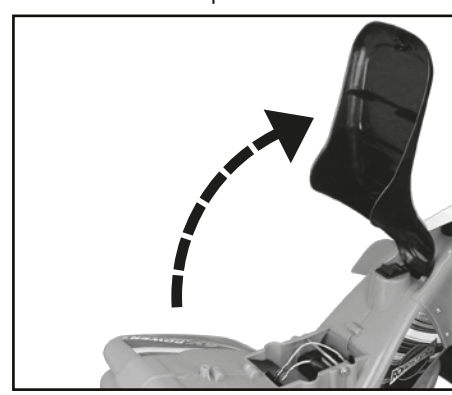

3. Close the seat and secure by a screwdriver.
4. Connect the charger's DC plug to the charging socket.

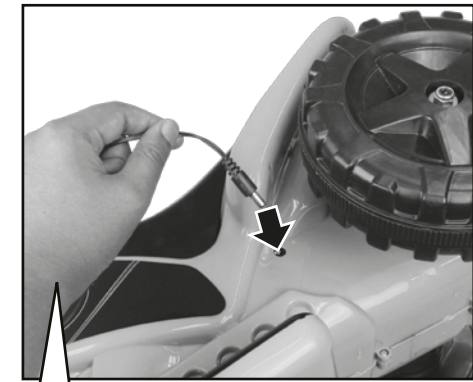
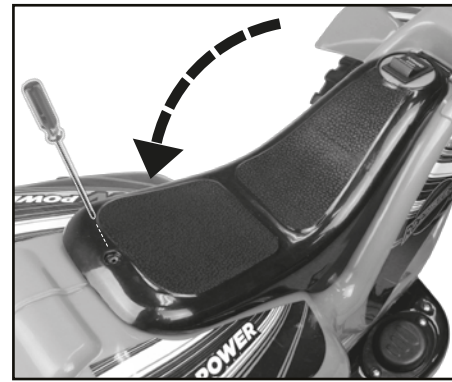

5. Plug the adaptor into the mains.

Battery charger model:
LK-D060050

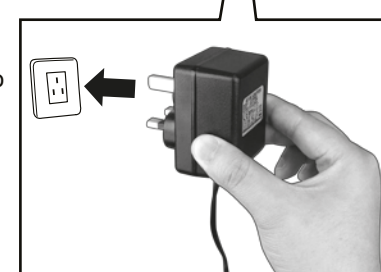

Page 2

Ready to Run!

- Turn on the main power switch.
- Press the Forward button to go forward.
- To stop, release the button.

Attention: Do not shift the power switch when vehicle in motion, this will damage the vehicle. Turn off the main power switch after use.

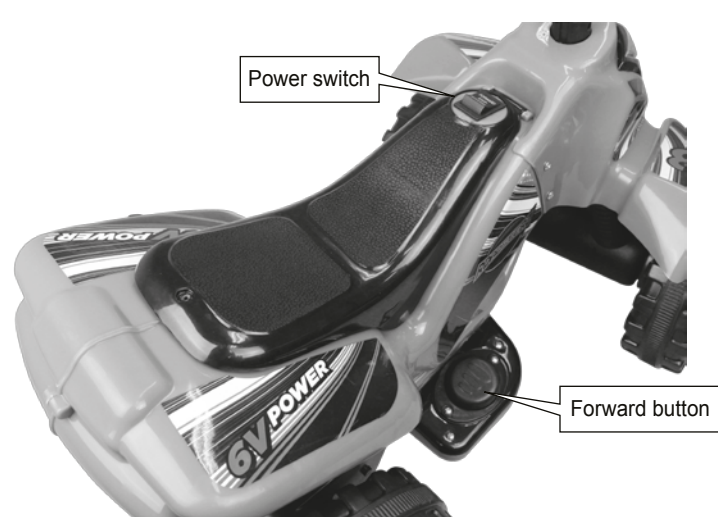

WARNING

1. Adult assembly only!
2. Do not allow children to open the protective cover on the battery compartment.

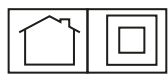

1. The battery charger is a Class II product with double insulation.
2. The battery charger is for indoor use only.
3. The battery charger is not intended for use by persons (including children) with reduced physical, sensory or mental capabilities, or lack of experience and knowledge, unless they have been given supervision or instruction concerning use of the appliance by a person responsible for their safety.
4. Children should be supervised to ensure that they do not play with the battery charger.

Page 3

Safety Battery Precaution

1. The supply terminals are not to be short-circuited.
2. Do not dispose of batteries in fire; batteries may leak or explode.

Cautions of Charging

1. The vehicle comes with the battery disconnected, please connect the battery and fully charge before use.
2. Connect the charger's DC plug to the charging socket and then plug the adaptor into the mains.
3. Please charge for 8-12 hours for 1-2 hours of driving. The charge time should not exceed 20 hours.
4. Recharge battery as soon as car performance starts to deteriorate in order to maintain battery life-span.
5. If the car is not used for a long period of time, charge the battery fully before storage and then recharge battery every 3 months to extend the battery life span.
6. Care should be taken to ensure all sockets and plugs are kept dry when charging.
7. Only the battery and charger supplied by the manufacturer should be used with this vehicle.
8. Care should be taken to ensure that the battery is connected and secured correctly.
9. Batteries should be removed from the car and properly disposed of when their life cycle is over.
10. Wires or any objects should never be inserted into any sockets.
11. In normal operation the charger will become warm (under 71C) and should not be cause for concern.

Page 4

Caution for Safety

1. Warning. Not suitable for children under 36 months. Choking hazard due to small parts. Hot surface hazard.
2. Suitable for children aged over 3 years. Maximum weight: 25 kg.
3. Warning. Protective equipment should be worn. Not to be used in traffic.
4. Always wear a helmet, gloves, knee and elbow pads.
5. Warning. This toy is unsuitable for children under 3 years due to its maximum speed.
6. Warning. Do not use this toy in areas other than private grounds.
7. Do not ride on the street, highway, slope, sand, or any other dangerous places.
8. Must be ridden on even ground. Do not overload when riding.
9. This toy should be used with caution to avoid casing injury.
10. This toy has no brake.

1. Charging of the battery must be done by adults.
2. Adult supervision is required at all times.
3. Do not change any of the car circuitry or any of the supplied electrical devices.
4. Please do not pour water or liquids on the car and keep vehicle dry at all times.
5. Do not push backward or forward whilst riding.
6. Recharge battery as soon as car performance starts to deteriorate in order to maintain correct battery life-span.
7. Do not ride on a rainy day.
8. Check the condition of all wiring, circuitry and plugs and any supplied electrical devices frequently and do not use if damaged and replace any damaged electricals immediately.
9. Check the charger regularly to avoid damage on the cord, plug, enclosure and other parts. In the event of any damage, do not use the charger until it has been repaired.
10. Disconnect charger before cleaning the vehicle.
11. The charger is not a toy.
12. Adult assembly is required.
13. Only one child to ride on the quad at a time.
14. Disconnect the supply before making or breaking the connections to the battery.
15. The battery charger is specially designed to charge the 6V4Ah lead-acid battery which is incorporated in this car. Do not charge other type of batteries.
16. Do not charge non-rechargeable batteries.
17. During charging, the battery/car must be placed in a well ventilated area.

Page 5