

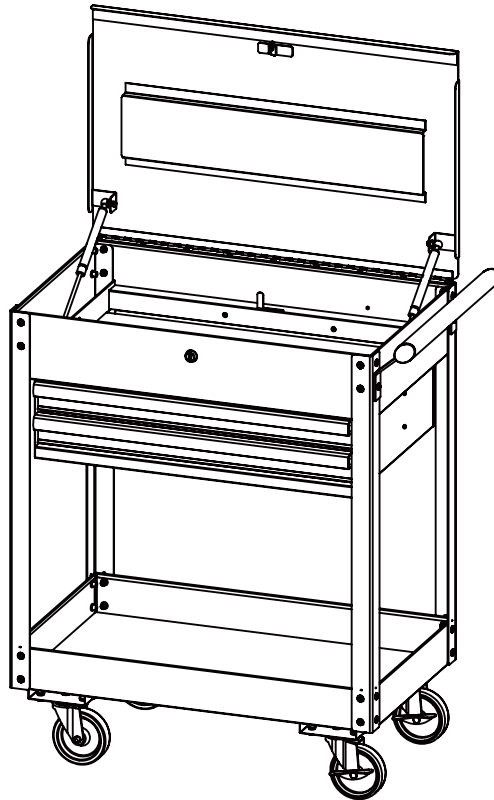

User Instructions

Halfords Advanced Series

Item Code:584083 Halfords Advanced 2 Drawer Cart



Caution:

Read and follow all information in this owners manual before use.

Keep for future reference.

Halfords Ltd. Redditch, B98 0DE.

SAFETY

SAFETY WARNINGS AND CAUTIONS

To avoid personal injury or product damage in use:

- Do not open more than one drawer at a time, this weight transfer could cause the unit to fall towards the user.
- Do not stand on the unit or in/on the drawers.
- Always ensure the castor locks are on when stationary.
- Only use this product on an even, level surface to prevent it from becoming unstable.
- When loading the cart, place heavier items on the bottom of the unit first then load the drawers/ top.
- Do not exceed the stated maximum weights listed below.
- Ensure that all of the drawers and top lid are fully closed and locked before moving.
- Always push and not pull the product on the swivel castor side.
- Not suitable for mounting on a truck bed or any other moving objects.
- Ensure fingers etc. are clear of the drawers and lid before closing.

Product Specifications

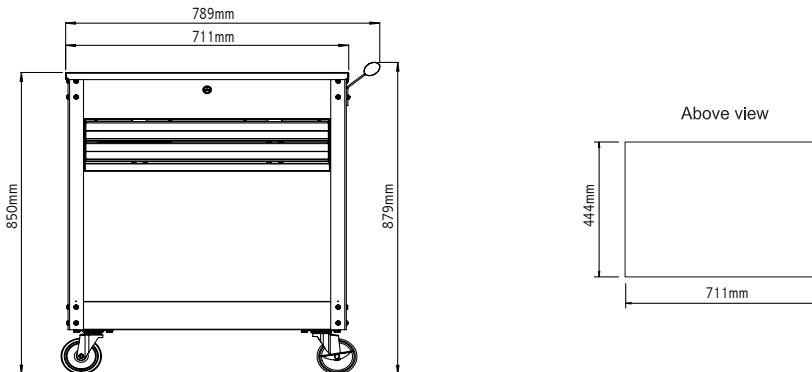

Drawer Dimension:

Row 1 to 2: 2xW=580mm H=58mm D=377.5mm

Maximum Weight per Drawer (x2): 25KG

Bottom Tray Dimension: 689 (W) x 420 (D) x 80 (H) mm

Maximum Weight per Tray (x2): 50KG

Maximum weight for Top Lid: 40KG

OPERATION

Part	Description	Qty
1	Drawer body	1
2	Bottom tray	1
3	Upright support	4
4	Side handle	1
5	Swivel castor without brake	2
6	Swivel castor with brake	2
7	M6x10 bolt	30
8	M6x14 bolt	2
9	M8x12 bolt	16

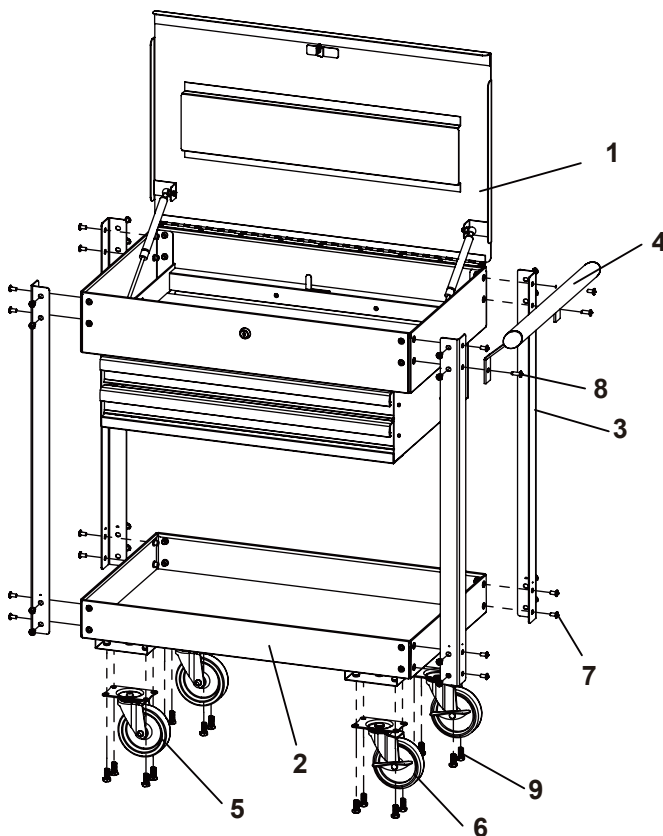

(1) ATTACHING UPRIGHT SUPPORTS TO BOTTOM TRAY AND DRAWER BODY

1. Loosely attach the 4 upright supports (3) to the bottom tray (2) using the M6x10 bolts (7).
2. With a helping hand, slot the drawer body (1) into the uprights, align the holes and loosely fit the top bolts (7).
3. The handle (4) can be placed into the lower mounting holes either side of the trolley. Use the longer bolts (8) to install the handle.
4. Fit the remaining bolts to the drawer body, square up the unit and tighten all securely.

(2) ATTACHING THE CASTORS

1. Ensure the drawers and top tray is locked shut then lay the cart down on its back.
Use the packaging material to protect the paint finish.
2. Mount both swivel castors with brake (6) on the same side of the cart as the handle.
3. Attach each castor using 4 bolts (9) to the bottom tray.
4. Return the cart to its upright position.

(3) REMOVING AND INSTALLING DRAWERS

Pull the drawer completely out, press down **right** tab and lift up **left** tab, pull drawer off slides.

To reinstall the drawer: Fully extend the runners, carefully slot the drawer back into the runner and press into the cabinet. Some resistance is normal however if a lot is felt, remove and realign.

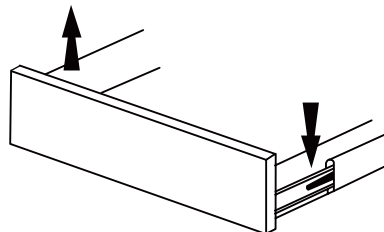

(4) LOCKING

Close all drawers and top before locking. The drawers are locked closed using the lever located in the rear of the top tray. If a drawer is not locked, unlock unit and push the drawer fully closed before re-locking.

MAINTENANCE

Drawer slides and castors should be lubricated periodically. (See Halford's lubricant range). Hardware (nuts, bolts, screws) should be tightened periodically to maintain trouble free operation.

WARRANTY

Please visit halfords.com/advanced for information on warranty period and full terms and conditions.