



TESTED
DIN 75302



MAX LOAD 50KG

For use with foot pack

PACK 2

725428

halfords

KIT 065 725279



Date/Year

AUDI A1	5 Door	2011->2018
CITROEN C4	5 Door	2010->2018
CITROEN DS4	5 Door	2011->2018
CITROEN DS5	5 Door	2012->2018
FIAT 500 L	5 Door	2012->
FIAT 500 L Living	5 Door	2013->
FIAT Bravo	5 Door	2007->2014
PEUGEOT 208	5 Door	2012->
PEUGEOT 508	4 Door	2011->2018
RENAULT Captur	5 Door	2013->
RENAULT Clio IV	5 Door	2012->
RENAULT Megane	5 Door	2008->2015
RENAULT Megane IV (Without Glass Roof)	5 Door	2016->
RENAULT Scenic / X-Mod	5 Door	2009->2016
RENAULT Talisman	4 Door	2016->
RENAULT Twingo	5 Door	2014->
VAUXHALL Astra K	5 Door	2015->
VAUXHALL Crossland	5 Door	2018->
VOLVO V40 II	5 Door	2012->
VOLKSWAGEN Jetta	4 Door	2010->2018

*Fit List correct at time of printing (Feb 2020)

To order spare parts please contact your local Halfords Store. Alternatively please contact Halfords customer services on (+44) 0345 504 53 53*

*Calls to 03 numbers from private phones (including mobiles) are charged at the local rate, and are included as part of any inclusive call minutes provided by your phone operator.

Calls may be recorded.

Halfords Customer Services Department,
Halfords Group plc,
Washford West,
Redditch,
Worcestershire,
B98 0DE

Visit us at: www.halfords.com

Components:

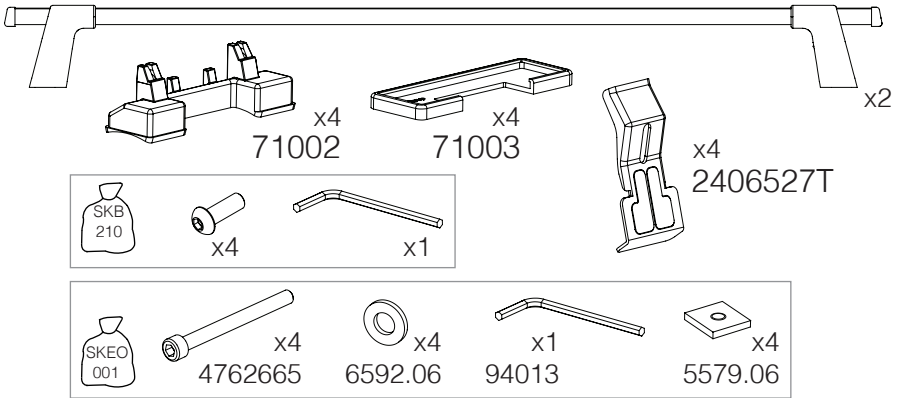

1

You will need to add the feet to the roof bars before fitting.

- 1 Remove the end caps from the bar.
- 2 Remove the covers from the feet.
- 3 Slide the foot pack onto the bar (do not tighten at this stage).
- 4 Replace the end caps back on the bar, leaving the covers off the feet for the next steps.

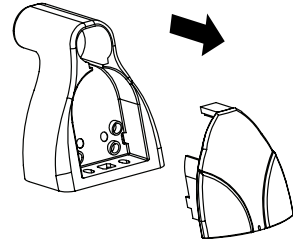

2

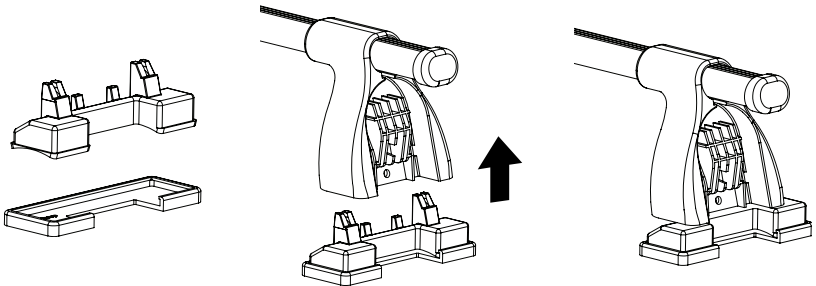

3

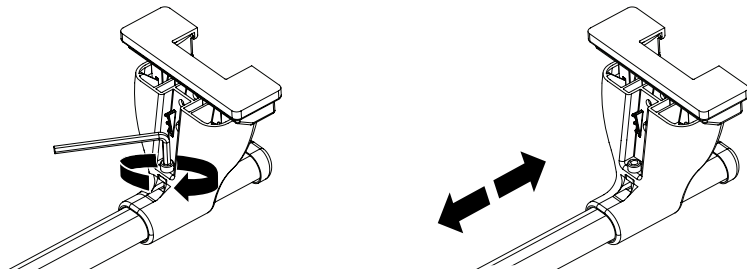

4

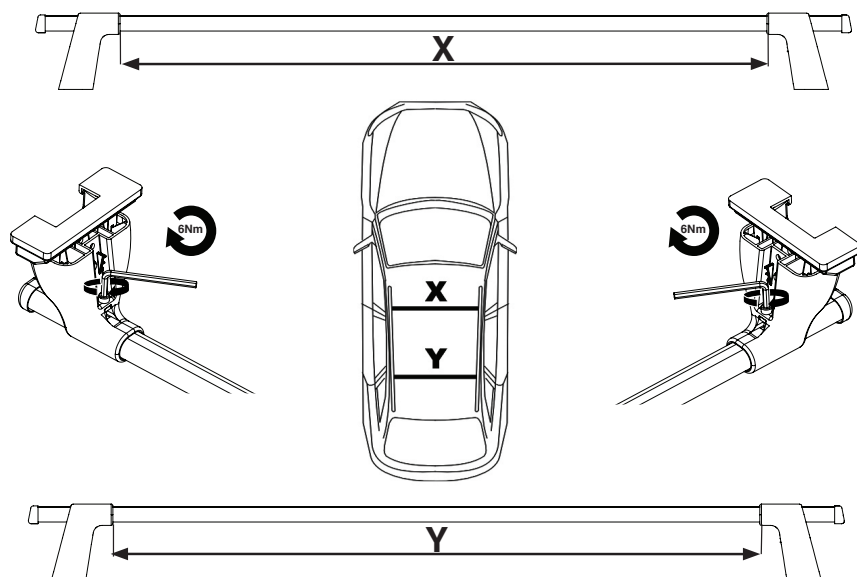

Brand	Model	Year	Door	X	Y	A (See fig 7 & 10)	B
Audi	A1	2011->2018	5	98 cm	96 cm	33 cm	68 cm
Citroen	C4	2010->2018	5	103 cm	103 cm	27 cm	71 cm
Citroen	DS4	2011->2018	5	103 cm	105.5 cm	25.5 cm	70 cm
Citroen	DS5	2012->2018	5	105.5 cm	99.5 cm	34 cm	68 cm
Fiat	500 L	09-2012->	5	106.5 cm	106.5 cm	47.5 cm	75.5 cm
Fiat	Bravo	2007->2014	5	107 cm	102 cm	33 cm	83 cm
Peugeot	208	07/2012->	5	98 cm	95.5 cm	22.5 cm	71 cm
Peugeot	508	2011->2018	4	104 cm	102 cm	30 cm	69 cm
Renault	Captur	04/2013->	5	100.5 cm	98 cm	32.5 cm	69.5 cm
Renault	Clio IV	09-2012->	5	101 cm	99.5 cm	30 cm	70 cm
Renault	Megane III	09/2008->	5	101 cm	99.5 cm	36 cm	70 cm
Renault	Megane IV (Without Glass Roof)	2016->	5	104 cm	104.5 cm	27.5 cm	70 cm
Renault	Scenic III	2009->2017	5	109.5 cm	109.5 cm	30 cm	70 cm
Renault	Talisman	2016->	4	106 cm	105.5 cm	28.5 cm	70 cm
Renault	Twingo III	09/2014->	5	99 cm	95.5 cm	30 cm	70 cm
Vauxhall	Astra K	2015->	5	101 cm	101 cm	29 cm	70 cm
Vauxhall	Crossland	2018->	5	104.5 cm	104.5 cm	27.5 cm	70 cm
Volvo	V40 II	03/2012->	5	98 cm	95 cm	25 cm	74.5 cm
VW	Jetta	2010->2018	4	99 cm	98.5 cm	27.5 cm	75.5 cm

Always adhere to the dimensions shown in the table. If you're in any doubt please contact the retailer.

5

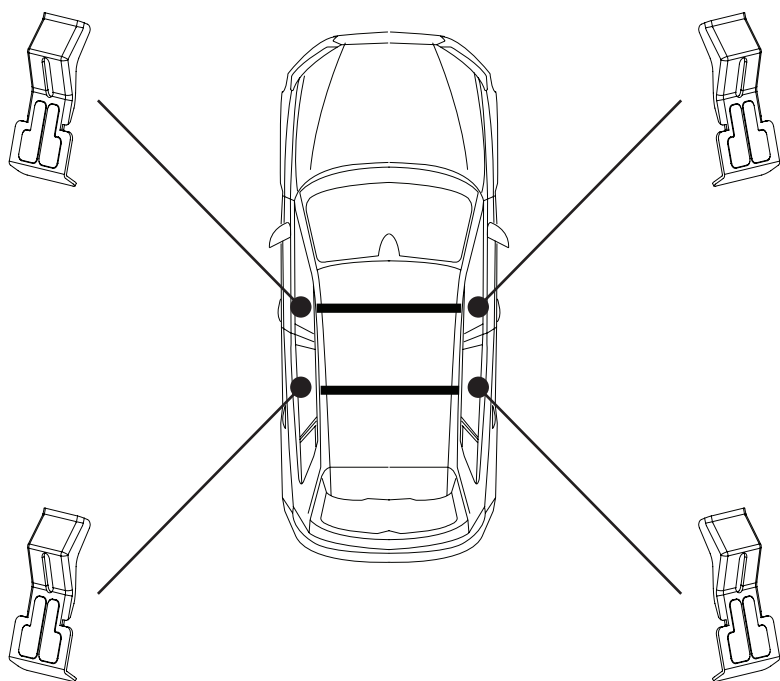

6

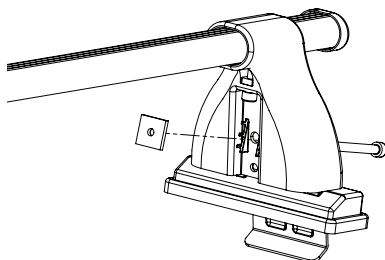
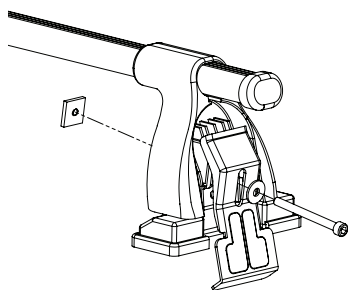

7

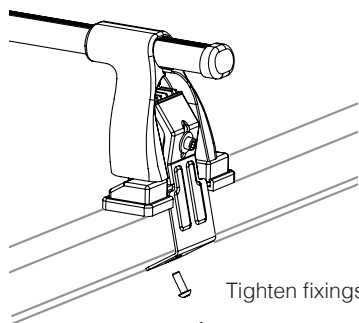
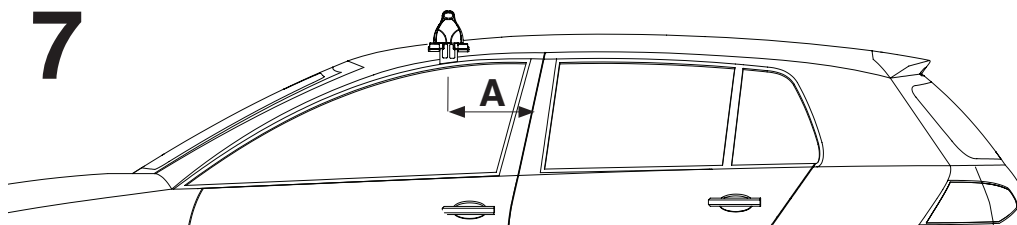

Tighten fixings alternately

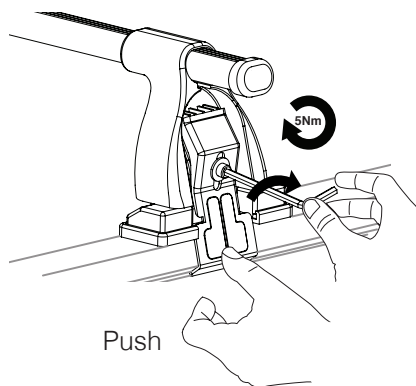
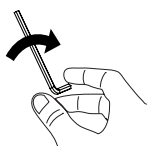

Push

8

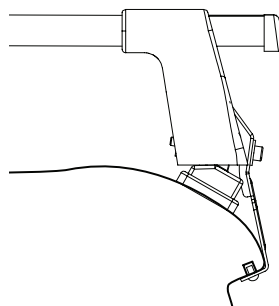
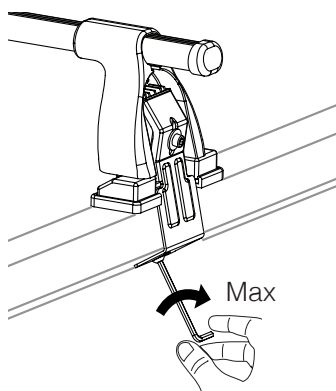

9

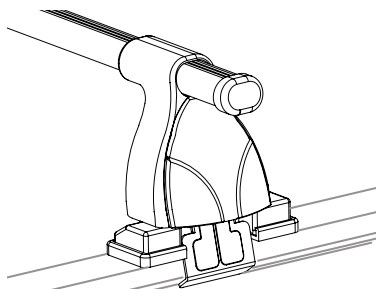
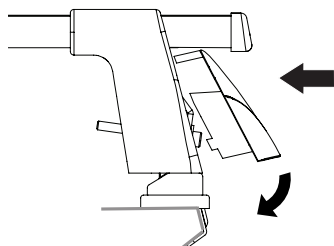

10

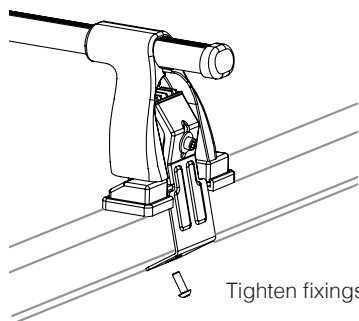
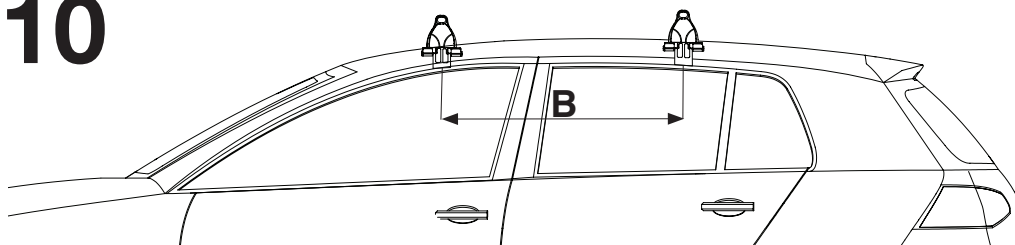

Tighten fixings alternately

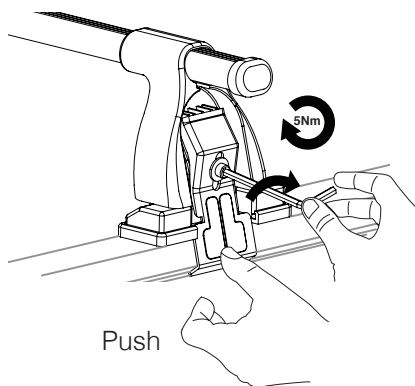
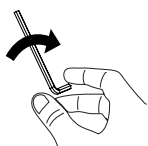

Push

11

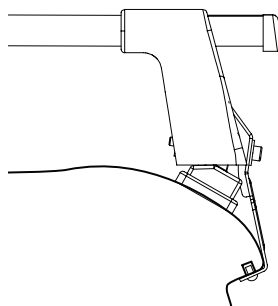
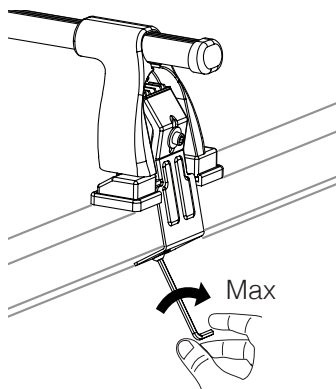

12

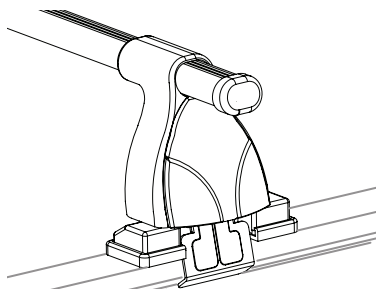
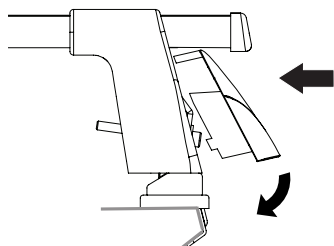

13

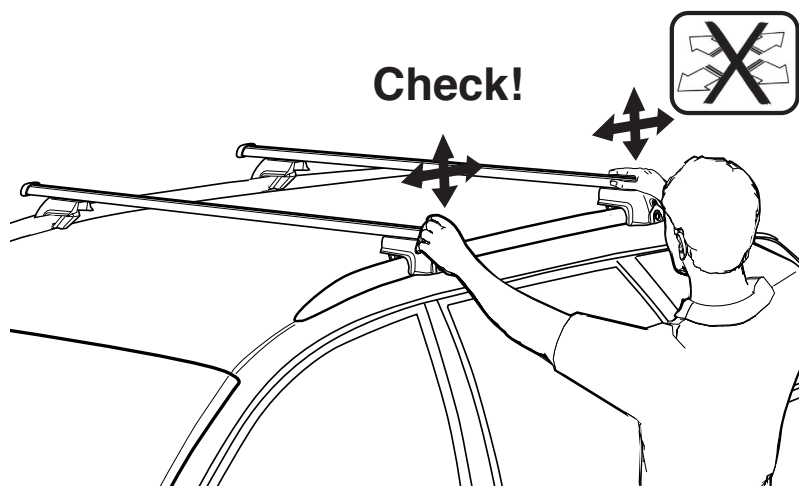

14

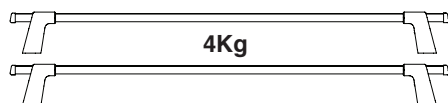
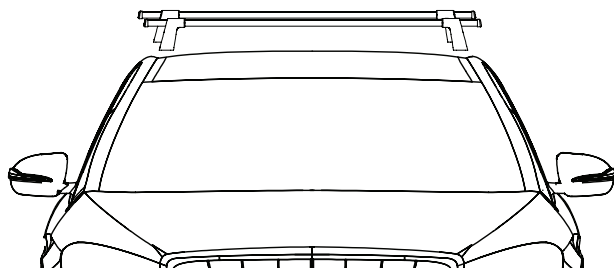

+



=



Do not exceed the total weight permitted on the vehicle roof.
For disassembly, perform these steps in reverse.

Installation Notes:

- Fit the roof bars according to the instructions only. Do not assemble or use this product unless you have understood the fitting instructions. If you have any questions, please contact your local store for further information. Check with the instruction manual that all the necessary parts are included.
- Check and make sure that all fastening parts are fixed securely. Please check also that the load is fastened properly by pushing and pulling it. Recheck regularly.

Important Safety Notes:

- Please retain the Hex key provided and these instructions safely with your car owners manual, for future reference.
- The maximum permissible load evenly distributed over the full width of the bar with a low centre of gravity is 50kg (including the weight of the bars, 4kg). Check the vehicle handbook for fixing location for the roof bar and the maximum permitted load. The maximum permitted roof load must be the lowest quoted figure. And if the vehicle handbook states a maximum of less than 50kg, then that is the maximum permissible load. Even if the vehicle handbook states a maximum of 120kg, the maximum permissible load for these roofbars is 50kg.
- It is your responsibility to ensure that all loads are correctly and safely secured using suitable fixing methods (e.g. strong webbing straps with buckles). Where specialised accessories are available, they should be used (e.g. Cycle Carriers, Ski Holders, etc). If small heavy loads are being carried, load to one side of the bar, not the middle. Never attach loads to roof bars using bungee cords or elasticated straps.
- Before driving and at regular intervals during your journey, check that all securing screws, clamping devices and foot attachments are fully tightened, in accordance with these instructions. Additionally ensure the load is fastened correctly.
- After covering a short distance, all securing devices of both the load and the load carrier must be checked and tightened as required. This must be done at suitable intervals, depending on the nature of the road.
- To prevent damage or discolouration to the paint under the foot pack rubber, we recommend the cleaning of the load bar feet and the vehicle roof prior to fitment. The load bar should be removed at regular intervals to repeat this process.
- When fitted, the roof bars will affect your fuel economy, therefore please remove when not in use.
- Neither the roof bars nor load must project beyond the maximum profile of the vehicle.
- Take care not to drive into low places such as garages or multi-storey carparks when carrying a high load, particularly cycles. Do not drive through an automatic car wash with the load carrier mounted on the vehicle
- Using the bars, especially when carrying a load, will affect the

- Please note that some antennas and sunroofs can interfere with the roof bars or accessory when installed and should not be used, if so.
- Follow the instructions thoroughly and do not jump ahead in the sequence (1,2,3, A,B,C,... etc).
- Please note there is a measuring guide on the packaging which can be used to align the roof bars when fitting them.

driving and braking characteristics of your car. Larger roof loads may also affect your car's sensitivity to cross winds. For safety reasons, the vehicle must not be driven at maximum speeds. Speed should be matched to the load being transported, to prevailing conditions including the state of the road, the quality of the road surface, the volume of traffic, etc., and of course any speed restrictions in force. Where there are no restrictions in force, we recommend a maximum speed of 65 mph, but the vehicle speed when transporting a load of any kind must be matched to the prevailing conditions.

- Surfboards, boats and large flat objects may produce damaging aerodynamic forces to the vehicle, out of all proportion to their dead weight. We therefore recommend travelling at much reduced speed when carrying these articles. **Where two or more surfboards are carried (or similar items which may produce lifting forces) they should not be carried side by side, but should be stacked one upon the other. They should be secured independently to the front and rear of the vehicle using strap or methods which are capable of withstanding the lifting forces.**
- When carrying kayaks or canoes ensure that they are secured to the bars and also the front and rear of the vehicle in the upright position.**
- The roof bars must be kept clean and properly maintained, particularly during the winter months when dirt and salt must be removed. Bolts, screws and nuts should be lubricated at suitable intervals, the periodic use of a spray lubricant will keep any lock barrels working freely.
- Always fit the roof bars in accordance with these instructions. The spacing between the front and rear bars must never be less than 700 mm, except where the vehicle mountings determine the spacing.

IMPORTANT: This load carrier is especially designed for your car model. Please therefore check with your retailer which type of load carrier is needed when changing your car. Do not use spare parts from other products without checking with your retailer. Do not put the car through an automatic car wash when the load carrier is mounted. The manufacturer takes no responsibility for damage caused by an incorrectly fitted load carrier.

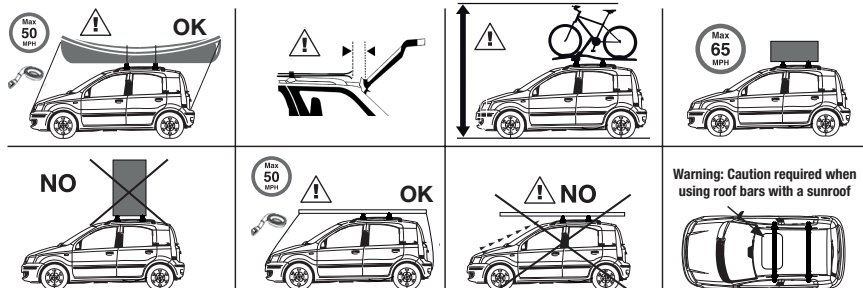

Made in the EU

Halfords Ltd, Icknield Street Drive, Washford West, Redditch, B98 0DE

Visit us at: www.halfords.com